

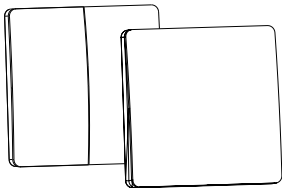

LUCESCO
light for life

Wireless Kinetic Energy Switch

Installation Instruction



Self Powered



No Maintenance



No Wiring



Durable



Cost Saving



Before first use please read instructions carefully.

Digital Instructions



<https://tinyurl.com/smart-switch-install>

Contents

Switch Block



Double Sided Adhesive
Tape



*The components detailed in this installation instruction are for reference only. Actual components may vary slightly.



Specifications and models

wireless kinetic energy switch technical parameters

Power supply: Micro energy acquisition and self generating(no battery)

Operating frequency: 433MHz

Control distance: 80m (outdoor), 30m (indoor)

Control method : pairing with wireless receiving controller

Quantity of keys: 1-2 keys

Usage: 150000 times

IP rating: 65

Operating temperature: -20°C to 40°C



1 Switch

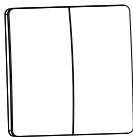

2 Switch

- * Test result: is from actual distance in laboratory.
This switch is for indoor lighting control use only.
The best way to use this switch is mount it on wall, we do not suggest using it remotely as it could cause the switch to be misplaced or dropped.
- * Warning: this switch has precision devices inside. Dropping of switch will likely cause damage.



Installation Methods

Two installation methods for wireless kinetic energy switch:

1 Adhesive installation method:

- 1-1 Applicable environment: glass, marble, ceramic tile and other smooth surface
- 1-2 Choose the installation position; clean the surface to ensure no oil/water etc. Ensure that it is dry.
- 1-3 Take the double sided adhesive tape, paste the tape on the bottom of switch in accordance with the mark on the bottom
(See diagram 1-1A-01)



diagram 1-1A-01

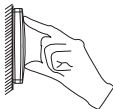

diagram 1-1A-02

- 1-4 Paste the switch on surface; it will be fixed completely after few hours (See diagram 1-1A-02)



2 Plate installation

2-1 Applicable environment: flat wall such as gyprock wall

2-2 First remove the switch buttons from the switch block
(refer to diagram 2-2A)



diagram2-2A

2-3 Use expansion screws to fix the switch block on the wall.

Care should be taken to ensure that switch block is orientated with the switches at the bottom of the switch block.
(refer to diagram 2-2B)

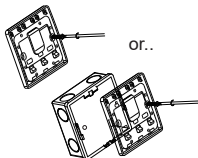

diagram 2-2B

2-4 Replace switch buttons by pressing into place
(refer to diagram 2-2C)



diagram 2-2C



Pair with controller

The Lucesco Smart Switch needs to be paired with a Lucesco wireless controller. The ordinary pairing method is to press and hold the controller "pairing key" button when the indicator light flashes and then press a button on the Smart Switch once (do not press continuously).

The indicator light goes off, which means that the pairing is successful.

Now the wireless controller can be controlled by this button.

For more detailed steps, please refer to the receiving controller instruction)

Directional pairing between two button switch and controller

To initiate directional pairing hold the "pairing key" on the controller for 3 seconds approx and release after LED indicator start flashing.

Then press one of the Smart Switch buttons four times (within 0.5 seconds), the indicator light goes off, which means pairing is successful.

After directional pairing is successful, the left button can only turn off and the right button can only turn on.

